

Commisioning

7. Push the product into place in the housing ensuring that you do not trap the cable. Secure in position.
8. This product comes with two wall covers, a plain and slotted, that can be fitted.
9. Locate the seal and glass in position. refit the desired cover, and replace screws. See Fig. 2.
10. Replace fuse or circuit breaker and switch on. Your light is now ready for use.

Fitting / Replacing Bulbs

When changing a bulb, always switch off at the mains and allow the bulb to cool before handling. Dispose of used bulbs carefully.

Do not exceed the wattage stated or use a different shape bulb from that indicated on the fitting.

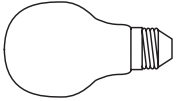
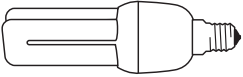
| |
|--|
| 40W ES GLS |
|  |
| 9W ES Energy Saver |
|  |

Care and Cleaning

We recommend cleaning with a soft dry cloth.

Do not use solvents or abrasive cleaners as these could damage the finish.

Glass parts - Remove and wash in warm water or just use a damp cloth. Do not use abrasive materials as these will damage the finish.

Recycling Advice



Waste electrical products should not be disposed of with household waste. Please recycle where facilities exist. Check with your Local Authority or retailer for recycling advice.

Safety Information

For your safety, always switch off the supply before changing lightbulbs, or cleaning.

This system contains non-replaceable parts and cannot be serviced. If damage occurs the part should be scrapped.



Saxby Lighting Ltd. BH23 3PE

saxby
lighting



Eco

OL60AB

Thank you for purchasing this light fitting.
 Please read the instructions carefully before use to ensure safe and satisfactory operation of this product.
 Please retain these instructions for future reference.

Warning

This is a Class I product and must be earthed.
 Please read these instructions carefully before commencing any work.
 This unit must be fitted by a competent and qualified electrician.
 Install in accordance with IEE Wiring regulations and current Building Regulations.
 To prevent electrocution switch off at mains supply before installing or maintaining this fitting.
 Ensure other persons cannot restore the electrical supply without your knowledge. If you are in any doubt, please consult a qualified electrician.
 This light fitting should be connected to a fused circuit.
 If replacing an existing fitting, make a careful note of the connections.
 Always use the correct type and wattage bulb. Never exceed the wattage stated.
 When changing a bulb, always switch off at the mains and allow the old bulb to cool down before handling. Dispose of used bulbs carefully and responsibly.
 Waste electrical products should not be disposed of with household waste. Please recycle where facilities exist. Check with your local authority or retailer for recycling advice.
 This product is rated at IP44.
 This product is not suitable for location in or near a marine environment.
 The entire unit gets hot whilst on for a period of time.
 This product is suitable for dimming when used in conjunction with a dimmable lamp. Please ensure verification of dimming abilities with the lamp manufacture prior to use.

Specification

| | |
|------------|----------------|
| Voltage: | 240V 50Hz a.c. |
| Lamp: | 40W E27 GLS |
| IP rating: | 44 |

Layout

- Plan the desired layout of this fitting carefully, ensuring the cables will reach the distance between the junction box and the light fitting.
- Avoid locating any cables in positions that would cause a hazard. Position cables and outdoor rated junction boxes (not supplied) away from areas where they may be at risk from being cut, trapped or damaged.
- We recommend that you use H05RN-F specification cable (not supplied) which is an outdoor grade, rubber sheathed cable. The mains supply cable must have a minimum cross sectional area of 1.0mm²
- Cables must be protected using suitable conduit or plastic trunking.

Installation

Existing fittings must be completely removed before installation of a new product. Before removing the existing fitting, **carefully note the position of each set of wires.**

- Undo the screws and remove the cover, glass and seal from the fitting.
- Cut the mounting hole for the light unit taking care not to damage any pipes or mains cables beneath the mounting surface 85mm high x 230mm wide x 75mm deep. Remove the rear surround from the fitting and ensure that it fits correctly in the hole and is level. See Fig. 1
- Fit the rear surround into position and secure. This surround may be cemented in position. Wait until the cement has set before continuing with the installation.
- Pull the cable through the rubber grommet and ensure that it is sealed to ensure that the fitting maintains its IP rating.
- Place the fitting in position, and secure.
- Wire as detailed below.

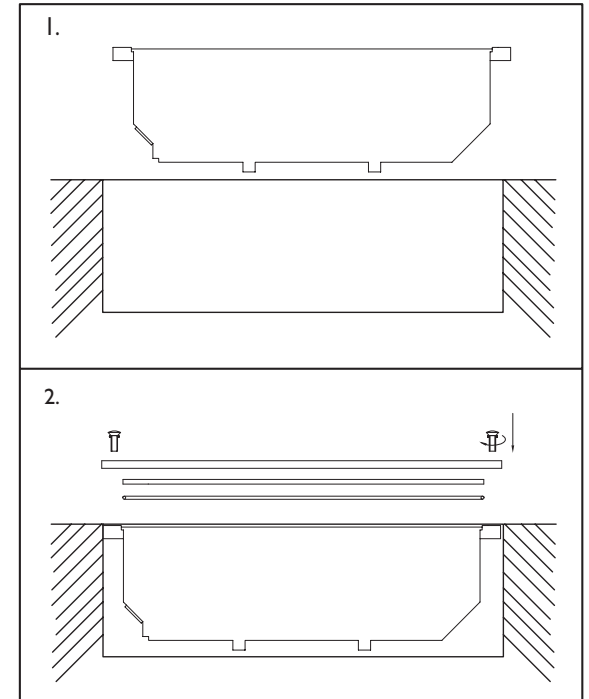

Wiring

Having correctly identified the wiring from your existing light fitting, pull the wire through the hole and connect to the connection block inside the product in the following way:

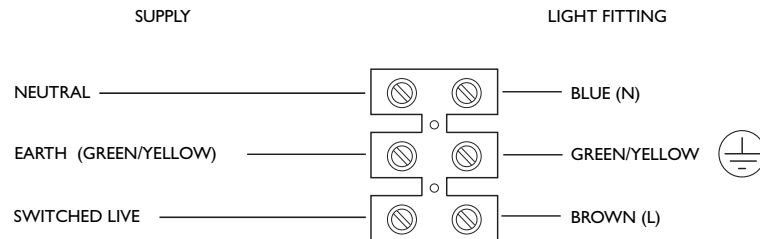

Check That

- You have correctly identified the wires.
- The connections are tight.
- No loose strands have been left out of the connection block.