

The luminaire should be positioned so that prolonged staring into the luminaire at a distance closer than 0.58m is not expected

Power (W)	Standard	DALI	Standard & P-Cell	AstroDim	Windage - Surface (m <sup>2</sup> )
60	5	5	5	5	0.20m <sup>2</sup>
45	5	5	5	5	0.20m <sup>2</sup>
30	5	5	5	5	0.20m <sup>2</sup>

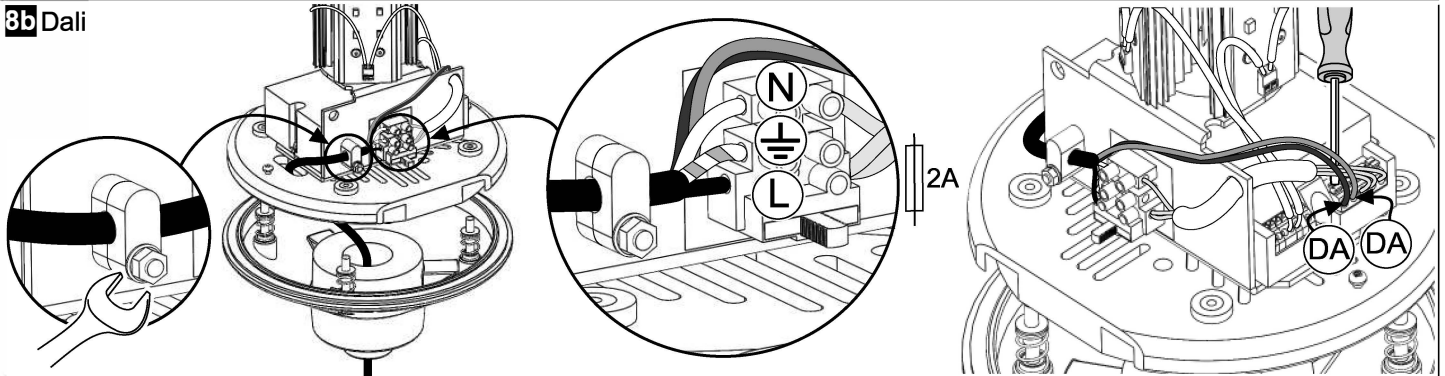

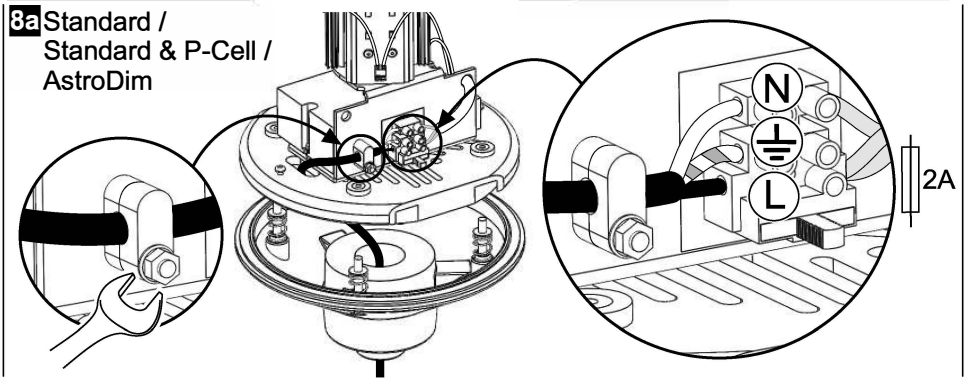
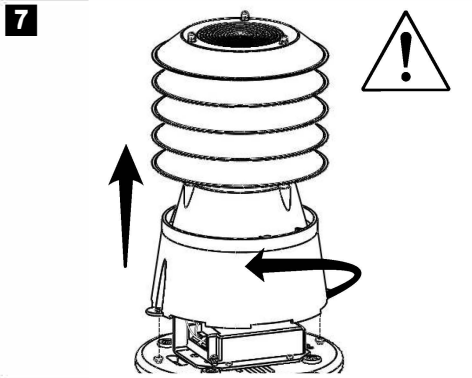
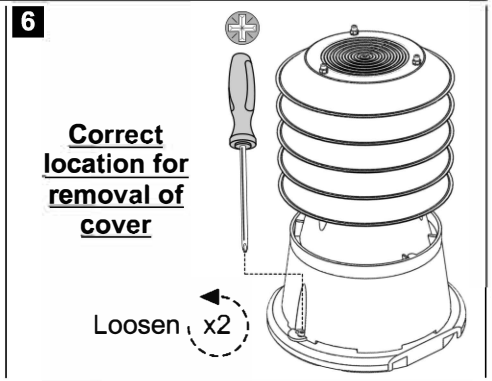
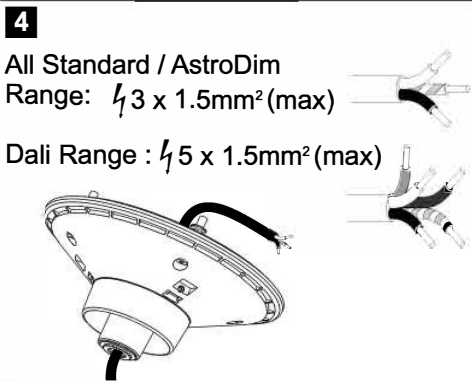
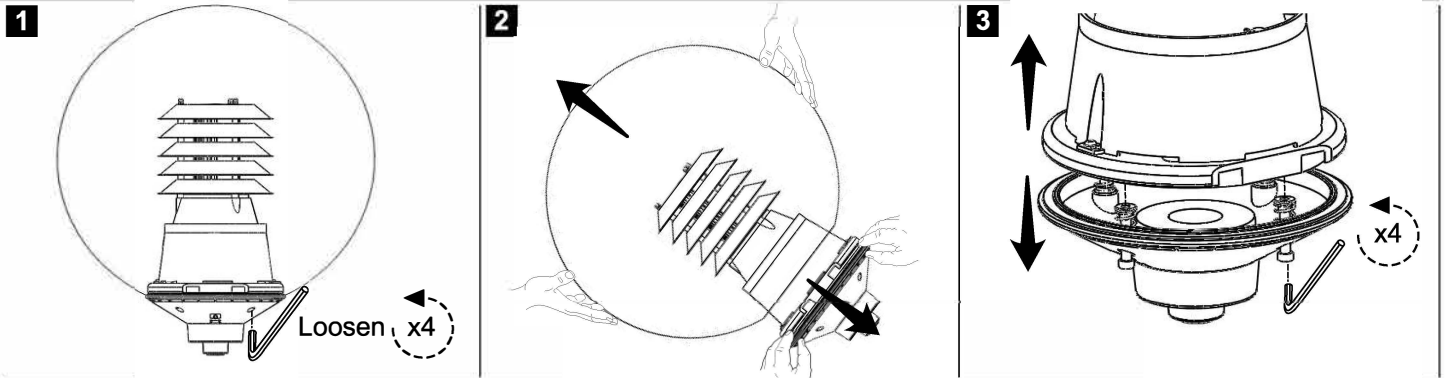
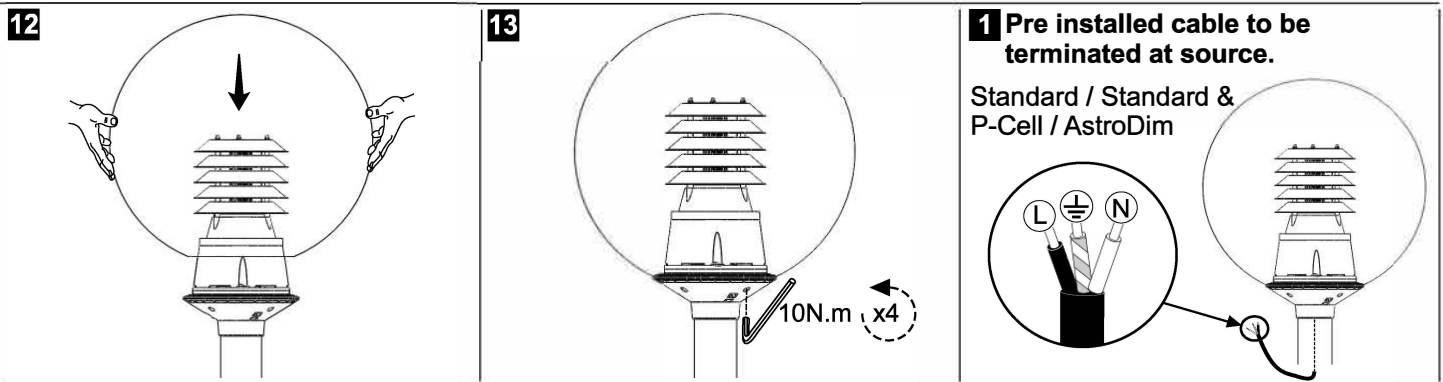
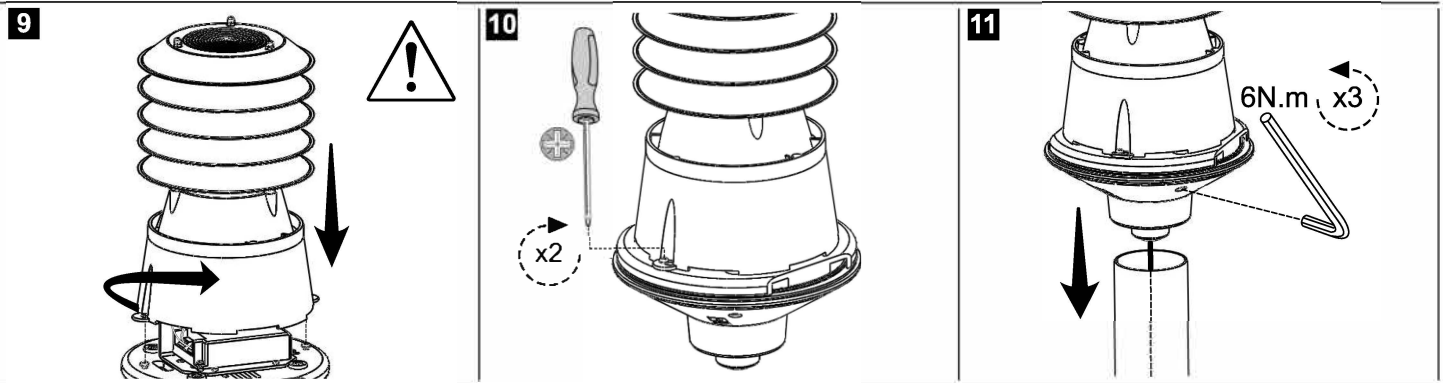

**1** Pre installed cable to be terminated at source.

Standard / Standard & P-Cell / AstroDim

**Optional Glare Shield (FIX0190)**

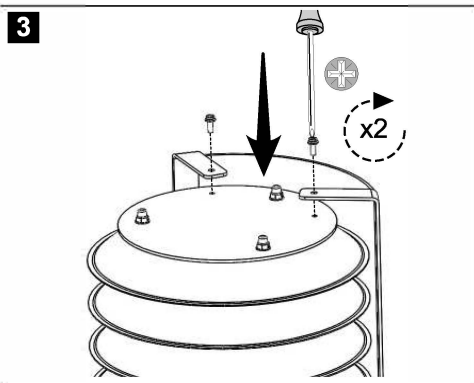
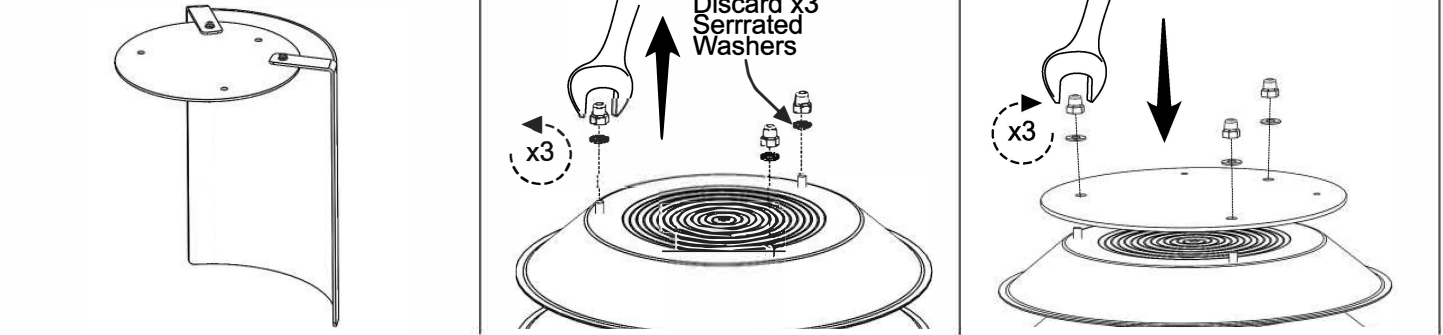

- Ensure no cables / wires are trapped during luminaire assembly.
- Care must be taken when removing / fitting luminaire louver to prevent LED damage.



**Operation & Maintenance**

Failed light source should be replaced promptly or the circuit switched off to avoid possible damage to control gear.

**Important - Safety**

Before carrying out any servicing on these luminaires, ensure that the mains supply is fully isolated.

Disconnect the luminaire before insulation testing of the installation.

Circuit Breaker Type	10A (B)	16A (B)	25A (B)
Standard Luminaire	7	12	20

**i** ta -20°C ... 40°C



The light source contained in this luminaire shall only be replaced by the manufacturer or his service agent or a similar qualified person.



**Example:** IP junction box / terminal block. If in doubt seek advice from qualified electrician.

**i1** Preparation of the ends of conductors: Wire ends striped to the length 7mm - 8mm. Add ferrules (for 1.5mm<sup>2</sup> mini wires) to the wires if they are stranded.

**i2** Terminal block specified:

- Terminal block specified:
- The type of terminals: Screw.
- Number of terminals: 3
- Rated voltage: 450V
- Rated connecting capacity: 16A to EN60598 and 24A to EN60998



**Example:**

Box: WISKA COMBI 308/5/S

Cable Gland x2: WISKA ESKVM20

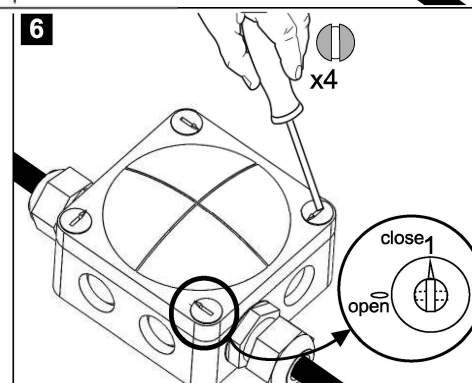
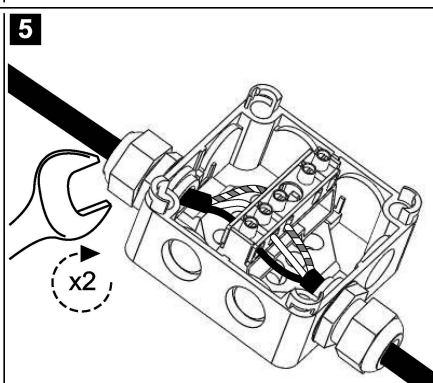
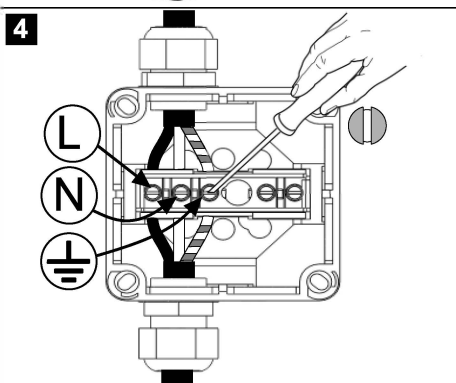
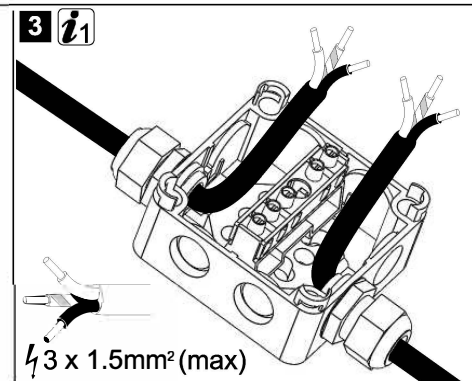
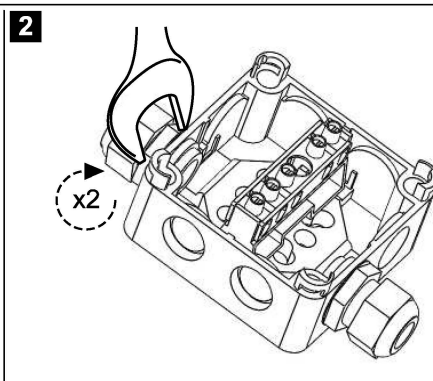
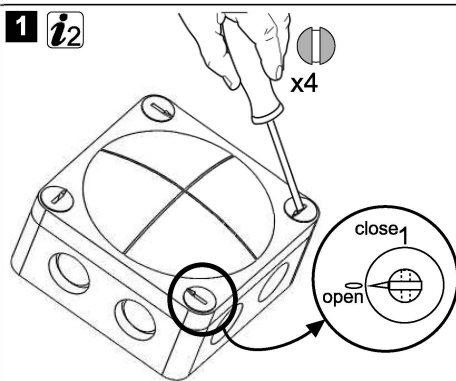

**Example:** Terminal block fused cut out. If in doubt seek advice from qualified electrician.

**i1** Preparation of the ends of conductors: Wire ends striped to the length 7mm - 8mm. Add ferrules (for 1.5mm<sup>2</sup>) to the wires if they are stranded.

**i3** Terminal block specified:

- Designed and tested in accordance with BS 7654:1997 and IEC/EN 60947-Part 1
- Detachable terminal block in extension trough facilitates termination of heavy duty cables
- Electroplated brass terminal blocks accept conductors up to 25mm<sup>2</sup>
- Number of terminals: 3
- The type of terminals: Screw
- Rated voltage: 230V
- Rated connecting capacity: 25A



**Example:**

Lucy zodion - Titan2

Single and double pole cut outs.

**1** **i3**

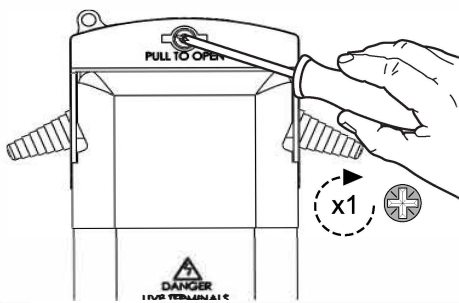

**2**

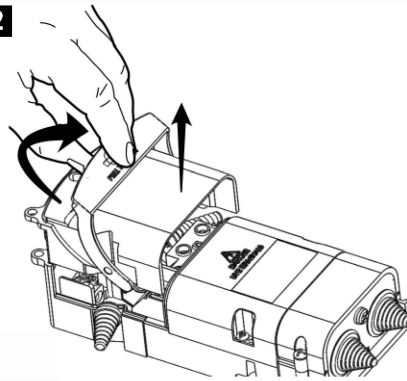

**3**

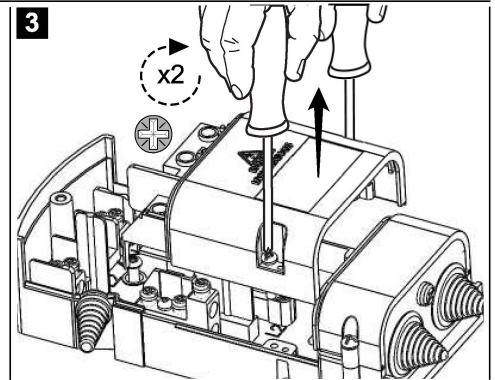

**4**

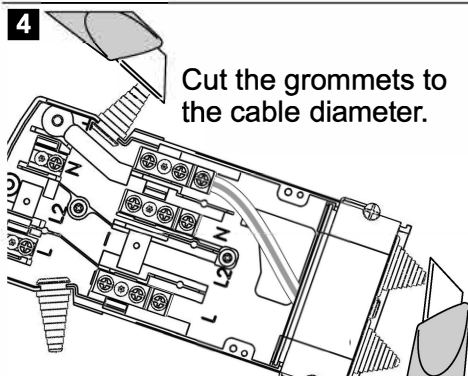

**5** **i1**

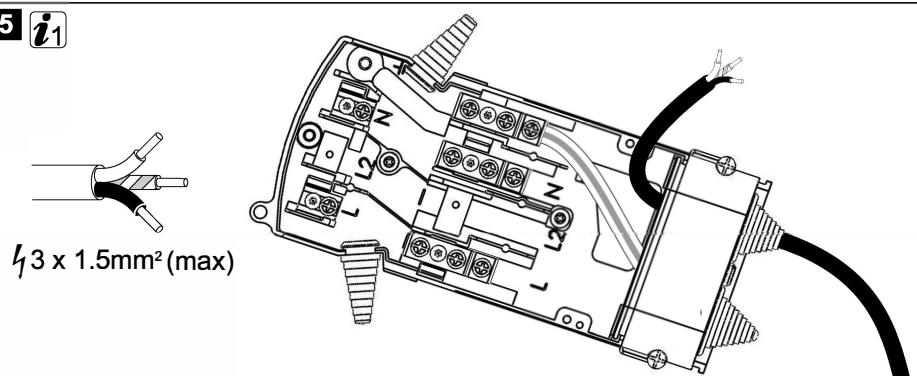

**6**

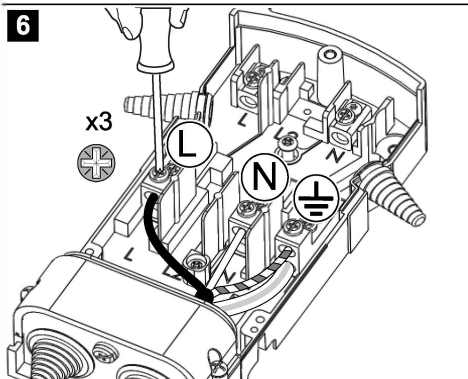

**7**

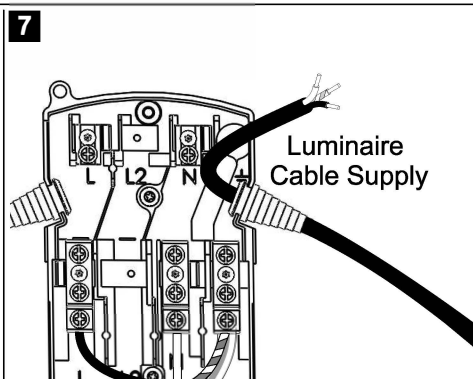

**8**

